

(A)LURE FUNCTIONS

Step into (A)LURE and discover a space where the beats are infused with funk, the food speaks for itself and the drinks take your tastebuds to a whole new world.

Our main dining room, private dining room and bar all offer something unique for your next party or function.

The menu is inspired - explore our collection of flawless dishes or sweeten up with some daring finishers. We can even tailor a menu to suit your needs.

Hit the bar and kick back with a drink amid the stylish sounds and open terrace.

(A)LURE will redefine how you look at a cocktail and wine list forever. Make it what you want.

Fill out the attached form and either fax it to 08 9362 7942 or post it to

(A)LURE  
Burswood Entertainment Complex  
PO Box 500  
East Victoria Park WA 6979

Alternatively you can drop this form at (A)LURE in person during opening hours.

# (A)LURE

Open seven days a week. Lunch from 12pm to 3pm. Dinner from 6pm.  
Bar open Sunday to Thursday 12pm to 3pm, then 6pm until late. Friday and Saturday from 12pm until late  
+61 8 9362 7551 [restaurants@burswood.com.au](mailto:restaurants@burswood.com.au)

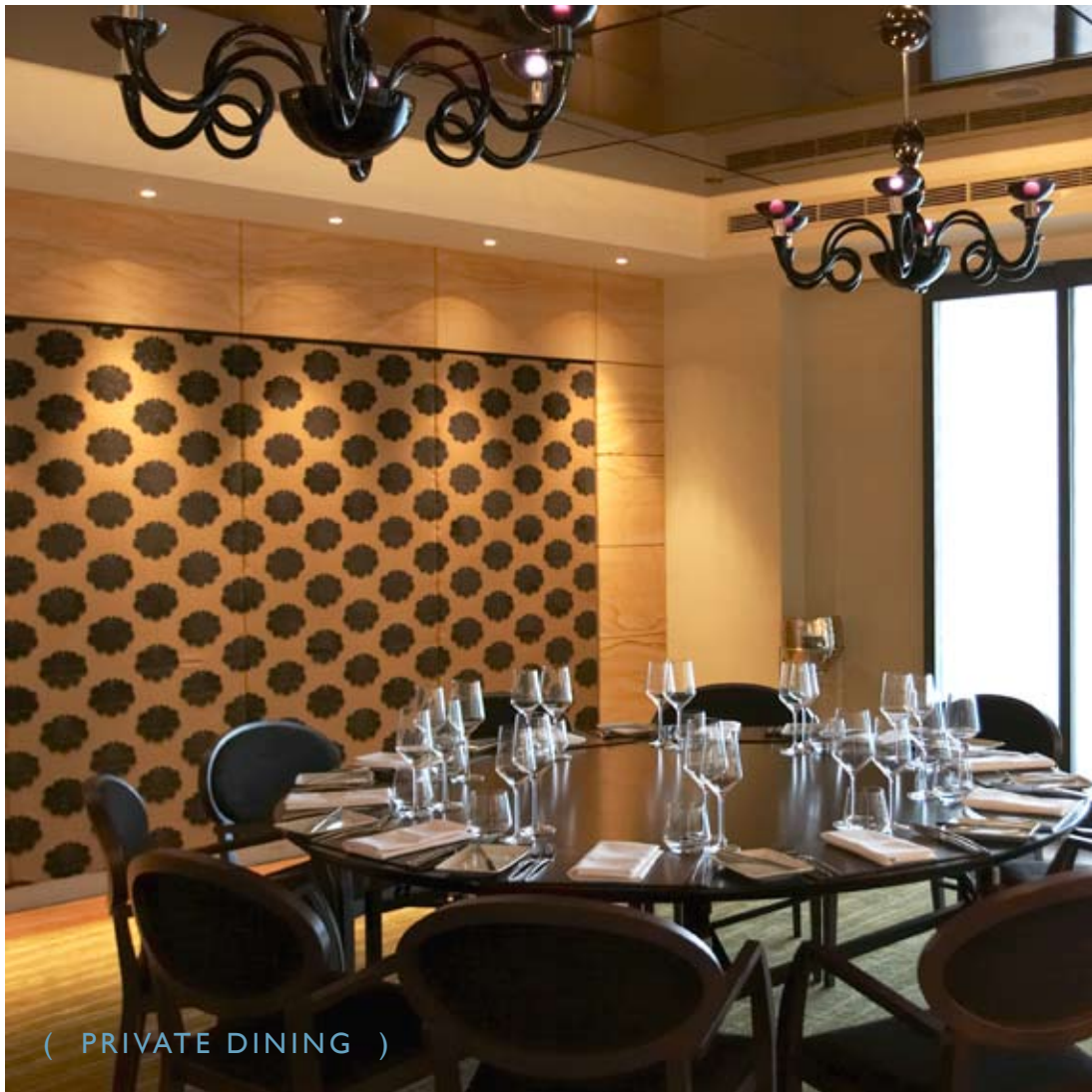

( PRIVATE DINING )

There's no other place like (A)LURE's private dining room for a glam, glittering and all round fabulous function or event. Parties, business lunches, celebratory dinners – (A)LURE is the place to make it happen.

Take a drink outside on the exclusive terrace overlooking the pool, while we take care of you with the ultimate in personal service.

Select from our sublime a la carte menu, or mix it up with one of our set food and beverage packages.

Our private dining room can accommodate up to 22 people, so get 22 of your favourite people together for an unforgettable dining experience.

The booking fee is \$300, and that makes it yours all night.

Whatever you're looking for, call us and see if (A)LURE is the venue for your next event!

**(A)LURE**

Open seven days a week. Lunch from 12pm to 3pm. Dinner from 6pm.  
Bar open Sunday to Thursday 12pm to 3pm, then 6pm until late. Friday and Saturday from 12pm until late  
+61 8 9362 7551 [restaurants@burswood.com.au](mailto:restaurants@burswood.com.au)



( SET MENU SELECTION )

( \$65 SET MENU )

Soup of the day

or

½ Dozen natural or Kilpatrick oysters

Moroccan spiced Ferguson Valley chicken,  
crispy confit leg, salted lemon,  
apricots, dates

or

Roasted Tasmanian salmon, sauce vierge

Trio of sorbets

or

Pistachio pavé, honey ice cream

Espresso coffee & fine tea

( \$75 SET MENU )

Chicken & goose liver parfait, pear chutney,  
toasted brioche, herb salad

or

Prawn & avocado cocktail, tomato crostini,  
white truffle lemon emulsion

Roasted red emperor, red pimento crust,  
chorizo risotto, soft saffron aioli

or

Dorper lamb best end, ratatouille, olive &  
goat's cheese pomme purée

Vanilla & crème fraiche cheesecake,  
berry compôte

or

Torrone ice cream, toffee centre,  
white chocolate crust

Espresso coffee & fine tea

\*Please note: dishes on this menu may contain substances which could have implications for individuals with food related health conditions, allergies or food intolerances

**(A)LURE**

Open seven days a week. Lunch from 12pm to 3pm. Dinner from 6pm.  
Bar open Sunday to Thursday 12pm to 3pm, then 6pm until late. Friday and Saturday from 12pm until late  
+61 8 9362 7551 [restaurants@burswood.com.au](mailto:restaurants@burswood.com.au)

( \$90 SET MENU )

Japanese tasting plate

or

Caesar salad of Pemberton marron,  
lobster emulsion, cos spears

Pan roasted dhufish, buttered spinach,  
warm tomato & caper herb dressing

or

Harvey beef fillet, grilled West Australian  
jumbo prawn, carrot purée, balsamic  
onions, braised beef cheek

Hot chocolate fondant, Baileys ice cream  
or

Artisan cheese, Muscat caramel,  
walnut bread, grissini, fig

Espresso coffee & fine tea

\*Please note: dishes on this menu may contain substances  
which could have implications for individuals with food  
related health conditions, allergies or food intolerances

( BEVERAGE SELECTION )

**\$38 PER PERSON**

Sandalford Classic White  
Sandalford Cabernet Merlot  
Rothbury Sparkling Cuvée  
Crown Lager  
Cascade Premium Light  
Soft drinks and juices

**\$48 PER PERSON**

Vasse Felix Chardonnay  
Vasse Felix Cabernet Merlot  
Vasse Felix Sparkling Brut NV  
Corona  
Crown Lager  
Cascade Premium Light  
Soft drinks and juices

These beverage packages are based on two hours.  
Management reserves the right to change packages & prices  
without notice due to vintage and availability.

**(A)LURE**

Open seven days a week. Lunch from 12pm to 3pm. Dinner from 6pm.  
Bar open Sunday to Thursday 12pm to 3pm, then 6pm until late. Friday and Saturday from 12pm until late  
+61 8 9362 7551 [restaurants@burswood.com.au](mailto:restaurants@burswood.com.au)



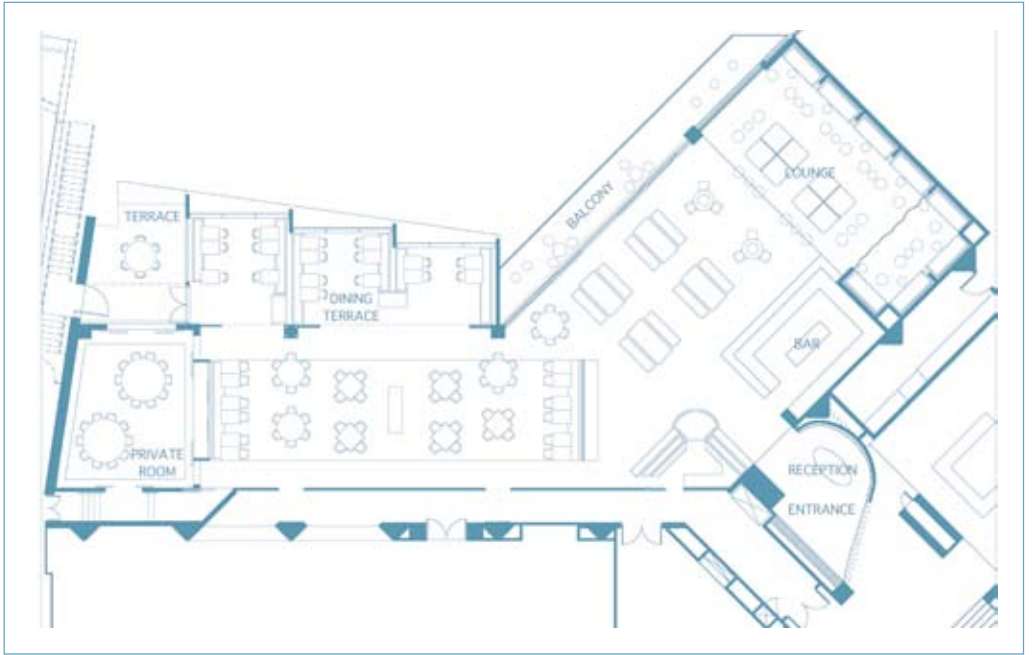

Big and bold with a grand menu, or intimate and indulgent with superb cocktails? Either way, (A)LURE is the space for you.

We can cater for up to 85 people in the main dining room, 200 people in the bar and lounge area, and 22 people in the private dining room.

## (A)LURE

Open seven days a week. Lunch from 12pm to 3pm. Dinner from 6pm.

Bar open Sunday to Thursday 12pm to 3pm, then 6pm until late. Friday and Saturday from 12pm until late

+61 8 9362 7551 [restaurants@burswood.com.au](mailto:restaurants@burswood.com.au)

( CANAPÉS SELECTION )



( HOT )

Salt and pepper squid

Tempura prawns, spicy lime salt

Pumpkin and feta tarts, truffle oil

Selection of satay sticks, peanut  
and coconut

Roasted Barramundi, piperade,  
chorizo, rouille

Hot oysters Kilpatrick

Pork and cashew gyoza, sweet chilli

( COLD )

Selection of sushi, sushi nigiri

Chicken parfait, spiced pear and vanilla

Persian feta, fig compote, crostini

Smoked salmon crêpe roulade,  
chives, capers

WA crayfish, Japanese mayo, wasabi

Chilled prawn, somen, wakame,  
bonito flakes

Spiced lamb loin, peach compote

Assorted oysters

( SWEET )

Assorted French pastries

Canapés \$4 each

Minimum \$20 spend per person

Platters available in the bar from \$50

\*Please note: dishes on this menu may contain substances which could have implications for individuals with food related health conditions, allergies or food intolerances

**(A)LURE**

Open seven days a week. Lunch from 12pm to 3pm. Dinner from 6pm.  
Bar open Sunday to Thursday 12pm to 3pm, then 6pm until late. Friday and Saturday from 12pm until late  
+61 8 9362 7551 [restaurants@burswood.com.au](mailto:restaurants@burswood.com.au)

## ( BOOKING FORM )

DATE

---

NAME OF GUEST

---

NAME OF COMPANY

---

TELEPHONE

MOBILE

---

FAX

EMAIL

---

PREFERRED METHOD OF CONTACT

---

DATE OF FUNCTION

NUMBER OF GUESTS

---

TYPE OF FUNCTION

---

FOOD REQUIREMENTS

---

---

APPROXIMATE SPEND

---

BEVERAGE REQUIREMENTS

---

APPROXIMATE SPEND

---

AUDIO VISUAL REQUIREMENTS

---

OTHER REQUIREMENTS (TABLECLOTHS, FLOWERS ETC.)

---

---

Burswood Entertainment Complex is committed to ensuring the privacy of your information. The information on this form will enable us to send you information about special offers and events at Burswood Entertainment Complex. If you DO NOT  wish to receive this information, please place a tick in the box provided.

Upon receipt of your booking sheet, a member of Burswood staff will contact you within 48 hours to discuss your function. Please note all menus are correct at the time of printing and may be subject to change.



## (A)LURE DINING ROOM

### ( TERMS AND CONDITIONS )

1. To hold your function in the (A)LURE Private Dining Room a \$300 room hire charge applies. There is also a minimum spend of \$1,000 for the function.
2. A deposit of \$300 minimum (together with a signed booking form – as attached overleaf) must be provided to Burswood Entertainment Complex within 7 days of booking the function (or immediately if the booking is made within 7 days of the function). Your booking will not be confirmed (and Burswood may release the function space) until receipt of such deposit and booking form.
3. For all functions including hens or bucks nights there is to be no inappropriate paraphernalia.
4. All tables of 10 or more are required to choose a set menu and pre-arrange beverage requirements. This includes choosing wines and/or beverage package.
5. For groups of 40 people or more, if cancellation or postponement occurs within 72 hours of the function, you must pay Burswood the full amount which would otherwise have been payable to Burswood if the function had been held (including the deposit referred to above). If cancellation occurs within 7 days of the function, your deposit will be forfeited to Burswood. For smaller groups of 15 – 40 guests, if cancellation occurs within 72 hours of the function, your deposit will be forfeited to Burswood.
6. You must advise Burswood of the final number of guests at least 72 hours prior to the function. You will be liable to pay the cost of the function as based on this final advised number even if the actual number of guests is less than this final number advised.
7. You must confirm the menu and beverage selections at least 7 days prior to the function. Listed menu prices featured in this brochure are subject to change at any time without notice at management's discretion.
8. You must, and you must ensure that your guests and invitees, strictly observe and comply with all applicable laws (including non-smoking laws), the rules and policies of Burswood (as varied from time to time), and any lawful directions of Burswood. You assume full responsibility of the conduct of your guests and invitees, and you must ensure Burswood's other guests and visitors are not disturbed by your function, guests or invitees. Burswood may refuse admission to, or eject from, the (A)LURE, the function, and / or the Complex any person who in Burswood's opinion is not conducting him or herself in a proper, orderly or lawful manner.
9. You acknowledge that Burswood practices the responsible serving of alcohol in accordance with its obligations under its liquor licence. You must comply and procure the compliance of your guests and invitees with the conditions of such liquor licence, any request from restaurant staff limiting the serving and or consumption of alcohol, and Burswood's guidelines and protocols for the responsible use of alcohol.
10. You are responsible for, and you release and indemnify Burswood, its employees and agents from and against, any loss, any claim, demand or damage however arising in connection with the function, except to the extent that such loss, claim, demand or damage is cause by Burswood or its employees or agents.
11. Without limiting any other rights Burswood has at law, Burswood may terminate the function if:
  - (a) you and or any of your guests or invitees fail to comply strictly with these terms and conditions; or
  - (b) an event which is beyond the reasonable control of you, (A)LURE or Burswood (including, without limitation, an Act of God, industrial relations action, a terrorist act or an accident) prevents the holding of the function.
12. For the purposes of these terms and conditions, "Burswood" means Burswood Entertainment Complex Limited ABN 35 491 489 282 and includes, where appropriate, the employees, agents and contractors of Burswood and the restaurant.

# (A)LURE

Open seven days a week. Lunch from 12pm to 3pm. Dinner from 6pm.  
Bar open Sunday to Thursday 12pm to 3pm, then 6pm until late. Friday and Saturday from 12pm until late  
+61 8 9362 7551 [restaurants@burswood.com.au](mailto:restaurants@burswood.com.au)

## (A)LURE BAR

### ( TERMS AND CONDITIONS )

If you require a sectioned area of the bar the minimum cost is \$200. If you would like to be located in the carpeted area solely, there is a minimum party size of 50 persons and a hire charge of \$500. The area can be sectioned using bollards or hedging as division of the area for the exclusive use of your party. Wristbands are also included to identify your party to the staff serving food and beverage.

If you would like constant security presence for your function this can be arranged through the Burswood Entertainment Complex security team. For each guard there is a charge of \$45 per hour. Any bar function exceeding 100 people will require security presence. At (A)LURE if you would like to have a DJ for the event we have partnerships with Extended Play. We do not allow independent DJ's to perform in our venue.

Contact details for Extended Play are:

Phone: 9286 4433

If you would like exclusive and sole use of the bar area the minimum spend for the function is \$15,000 on weekends, and \$10,000 mid week, plus an additional \$1,500 venue hire. Please note that the bar may not always be available for exclusive use and final approval must come from upper management (Crown LTD and IHG) to close the bar to the general public.

A \$300 deposit is payable to confirm and secure your space. Your booking will not be confirmed (and Burswood may release the function space) until receipt of such deposit.

(A)LURE encourages the responsible service of alcohol. Bar functions come with strong recommendations of food to be served throughout the event. In accordance with (A)LURE Bar policy, functions before 9pm must have catering of minimum \$5 per person.

If you would like tray service for beverage and food platters (excluding canapés), rather than ordering individually over the bar, on-charges per staff member (for minimum 2 hours) are as follows:

- \$25 per hour week days
- \$35 per hour week ends
- \$40 per hour public holidays

In the (A)LURE Bar there are to be no speeches under any circumstances. This is due to the fact that it disrupts the Dining Room floor during service. After 11pm a brief (i.e. 10 minute maximum) speech may be allowed at management discretion.

As part of the (A)LURE venue we have a balcony overlooking the pool. This area cannot be sectioned from other functions. Please advise your guests that there is NO GLASSWARE to be allowed on the balcony. There will be plastic cups made available as an alternative for you and your guests.

You, as function organiser will be liable for any damage to furniture, carpets, curtains, windows, swimming pool and poolside area that is caused in the course of your function by you or any of your guests.

## (A)LURE

Open seven days a week. Lunch from 12pm to 3pm. Dinner from 6pm.  
Bar open Sunday to Thursday 12pm to 3pm, then 6pm until late. Friday and Saturday from 12pm until late  
+61 8 9362 7551 [restaurants@burswood.com.au](mailto:restaurants@burswood.com.au)

For all enquiries call 9362 7551  
or email [restaurants@burswood.com.au](mailto:restaurants@burswood.com.au)

Visit [www.burswood.com.au](http://www.burswood.com.au) to find out more

(A)LURE